

*Showing sensor block and excitation board only*

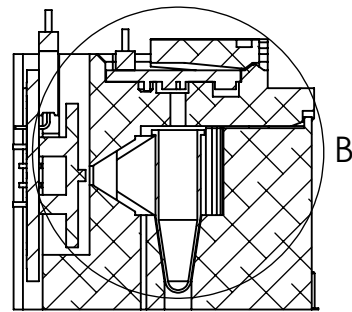

SECTION A-A

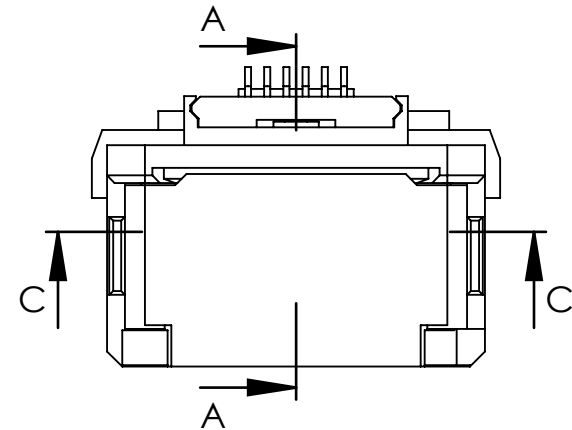

SECTION C-C

spectral sensor  $\phi 6.00$

Recommended fill  
between marks shown

Housing aperture  $\phi 2.0$

Sensor aperture  $\phi 0.5$

Right source ( $\phi 3$  or 5mm)

Left source ( $\phi 3$  or 5mm)

Center source (smt)

Standard PCR tube  
without lid

DETAIL B  
SCALE 2 : 1

STELLA -- NASA GSFC

**lab-spec\_plugin optical geometry for PCR tube configuration**

Dimensions in mm

Paul Mirel 20260403